



GLASFLÜGEL
ING. E. HÄNLE
7311 SCHLATTSTALL

TECHNISCHE MITTEILUNG
TECHNICAL NOTE

Nr: 205-4 e

Reference: Sailplane model Club Libelle 205
German Data Sheet Nr. 304, all Serial Numbers

Subject: Mounting attachment of the airbrake hinges

Reason: Improvement of production

Urgency: None; Modification optional

Method: The attachment screws M 5 x 14 according to specification LN 9037 with hexagon nuts M 5 according to specification LN 9348 and washers 5,3 according to specification DIN 9021-St of the airbrake hinges in the wing are replaced by tubular rivets according to drawing 205-56-62 and washers 5,3 according to specification DIN 125-St.

Material: According to drawing

Weight: No change

Remarks: This Technical Note is standard from Serial No. 62 and on.

GLASFLÜGEL

Ing. E. Hänle

March 4th, 1974

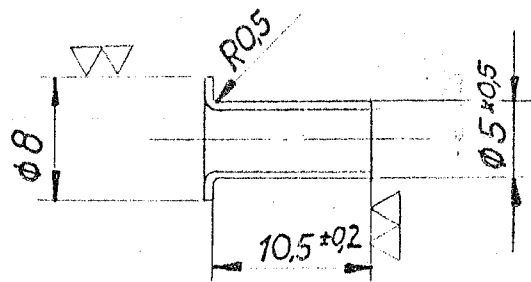

Stirnflächen entgratet

gefertigt aus Rohr 5x0.5x13.5 1.4571 DIN 2464



grüß
5. März 1975

	M2:1	Rohrriet für BK	205-56-62	26.2.75 JG
--	------	-----------------	-----------	------------